



Evolution Wireless Digital EW-DP 835 SET | Handheld Set



Portable digital UHF wireless microphone system with SMK-S handheld transmitter and MMD 835 cardioid dynamic microphone module for filmmakers, content creators, and broadcasters.

FEATURES

- Fully digital UHF wireless microphone system for video applications
- Integrated Bluetooth for synchronization and control
- Smart Notifications for troubleshooting and system guidance
- Intelligent battery management provides operating time (hours:minutes)
- Extended battery life: up to 12h on transmitter, 7h on receiver
- Magnetically stackable components for versatile mounting
- Industry leading 134 dB dynamic range for distortion free transmission
- Up to 56 MHz bandwidth for flexibility in any RF environment
- Exceptionally low latency (1.9 ms)
- External charging and powering via USB-C (receiver only)
- Smart Assist app for monitor & control
- Optional plug-on transmitter features XLR & 3.5 mm inputs, +48V & recording via microSD (ENG Set or component only)

DELIVERY INCLUDES

- EW-DP EK digital portable single channel receiver
- EW-D SKM-S digital handheld transmitter
- MMD 835 dynamic cardioid microphone module
- Mounting kit (Mounting plate, cold shoe, belt clip & screws)
- BA 70 li-ion battery & (2) AA battery
- Locking 3.5 mm TRS plug to 3.5 mm TRS plug cable
- Locking 3.5 mm TRS plug to XLR plug cable
- USB-C charging cable



Evolution Wireless Digital

EW-DP 835 SET | Handheld Set

SPECIFICATIONS

System		EW-D SKM-S (Handheld Transmitter)	
Audio link frequency ranges	Q1-6 470.2 – 526 MHz R1-6 520 – 576 MHz R4-9 552 – 607.8 MHz S1-7 606.2 – 662 MHz S4-7 630 – 662 MHz S7-10 662 – 693.8 MHz T1/7 694.5 – 702.7 MHz & 748.3 – 757.7 MHz T12 806.125 – 809.750 MHz T13-14 819.2 – 823.0 MHz U1/5 823.2 – 831.8 MHz & 863.2 – 864.8 MHz V3-4 925.2 – 937.3 MHz Y1-3 1785.2 – 1799.8 MHz	Input voltage	2.0 - 4.35 V
		Input current	< 300 mA
		Power supply	2 AA batteries 1.5 V (alkali manganese) or BA 70 rechargeable battery pack
		Occupied bandwidth	200 kHz
		Transmit power (radiated)	Audio link: 10 mW ERP (Range Y1-3: 12 mW ERP) BLE: max. 10 mW EIRP
		Dimensions (ø x l) (incl. MMD 835 microphone module)	50 x 268 mm (1.97" x 10.55")
		(without microphone module)	40 x 200 mm (1.57" x 7.87")
		Weight (without batteries) (incl. MMD 835 microphone module)	approx. 304 g (0.67 lbs)
		(without microphone module)	approx. 195 g (7.14 lbs)
Bluetooth® Low Energy (BLE) frequency range	2402 - 2480 MHz		
Audio frequency response	20 Hz - 20 kHz (-3 dB) @ 3 dBfs		
Audio THD	≤ -60 dB for 1 kHz @ -3 dBfs input level		
Dynamic range	134 dB		
System latency	1.9 ms		
Operating temperature	-10 °C - +55 °C (14 °F - 131 °F)		
Relative humidity	5 - 95 % (non-condensing)		
EW-DP EK		MMD 835 (Microphone Module)	
Input voltage	~ 1.8 - 4.35 V	Transducer principle	dynamic
Input current	Typ. < 250 mA / Max. < 400 mA (BA 70) Typ. < 400 mA / Max. < 750 mA (2x AA batteries) < 300 mA@ 5 V (USB-C standalone)	Sensitivity	2.1 mV/Pa
Power Supply	2x AA batteries 1.5 V or BA 70 rechargeable battery pack or USB-C PD power supply (max.): • 5 V / 1500 mA • 9 V / 900 mA • 12 V / 700 mA	Sound pressure level	154 dB SPL
Transmit power (radiated)	BLE: max. 10 mW EIRP	Pick-up pattern	cardioid
Audio output power	< 2 dBV max. (high level) / < 4 dBu max (high level)		
Headphone Output	< 50 mW into 16 Ohms		
Dimensions	86 x 67 x 28 mm (3.39" x 2.64" x 1.1")		
Weight (without antennas and power supply)	approx. 140g (without power supply) (0.31 lbs)		



Evolution Wireless Digital

EW-DP 835 SET | Handheld Set

MICROPHONE COMPATIBILITY

Microphone modules compatible with the EW-D SKM-S handheld transmitter

MMD 835-1	Dynamic microphone module with cardioid polar pattern
MMD 845-1	Dynamic microphone module with supercardioid polar pattern
MME 865-1	Pre-polarized condenser microphone module with supercardioid polar pattern
MMD 935-1	Dynamic microphone module with cardioid polar pattern
MMD 945-1	Dynamic microphone module with supercardioid polar pattern
MMK 965-1	Condenser microphone module with switchable cardioid and supercardioid polar pattern
MMD 42-1	Dynamic microphone module with omni-directional polar pattern
Neumann KK 204	Condenser microphone module with cardioid polar pattern
Neumann KK 205	Condenser microphone module with supercardioid polar pattern
MM 435	Dynamic microphone module with cardioid polar pattern
MM 445	Dynamic microphone module with supercardioid polar pattern
ME 9002	Pre-polarized condenser microphone module with omni-directional polar pattern
ME 9004	Pre-polarized condenser microphone module with cardioid polar pattern
ME 9005	Pre-polarized condenser microphone module with supercardioid polar pattern

PRODUCT VARIANTS

EW-DP 835 SET (Q1-6)	470.2 – 526 MHz	Art. no. 700030
EW-DP 835 SET (R1-6)	520 – 576 MHz	Art. no. 700031
EW-DP 835 SET (R4-9)	552 – 607.8 MHz	Art. no. 700032
EW-DP 835 SET (S1-7)	606.2 – 662 MHz	Art. no. 700033
EW-DP 835 SET (S4-7)	630 – 662 MHz	Art. no. 700034
EW-DP 835 SET (S7-10)	662 – 693.8 MHz	Art. no. 700035
EW-DP 835 SET (T1/7)	694.5 – 702.7 MHz & 748.3 – 757.7 MHz	Art. no. 700469
EW-DP 835 SET (T12)	806.125 – 809.750 MHz	Art. no. 700470
EW-DP 835 SET (T13-14)	819.2 – 823.0 MHz	Art. no. 700471
EW-DP 835 SET (U1/5)	823.2 – 831.8 MHz & 863.2 – 864.8 MHz	Art. no. 700036
EW-DP 835 SET (V3-4)	925.2 – 937.3 MHz	Art. no. 700038
EW-DP 835 SET (Y1-3)	1785.2 – 1799.8 MHz	Art. no. 700039

ACCESSORIES

Mounting Plate Set	Mounting kit for EW-DP (Mounting plate, mounting screws, cold shoe mount, allen key, and belt clip)	Art. no. 700005
Mounting Plate	Single mounting plate	Art. no. 588188
CL35	3.5 mm to 3.5 mm TRS coiled cable	Art. no. 586365
CL35-Y	3.5 mm to dual-3.5 mm TRS coiled cable	Art. no. 700061
CL35XLR	3.5 mm to XLR plug coiled cable	Art. no. 700062
BA 70	Rechargeable battery pack for SK and SKM-S	Art. no. 508860
L 70 USB	Charger for BA 70 rechargeable battery pack	Art. no. 508861
EW-D CHARGING SET	Set of L 70 USB charger and 2 BA 70 rechargeable battery packs	Art. no. 508862



Evolution Wireless Digital EW-DP 835 SET | Handheld Set

DIMENSIONS

EW-DP EK

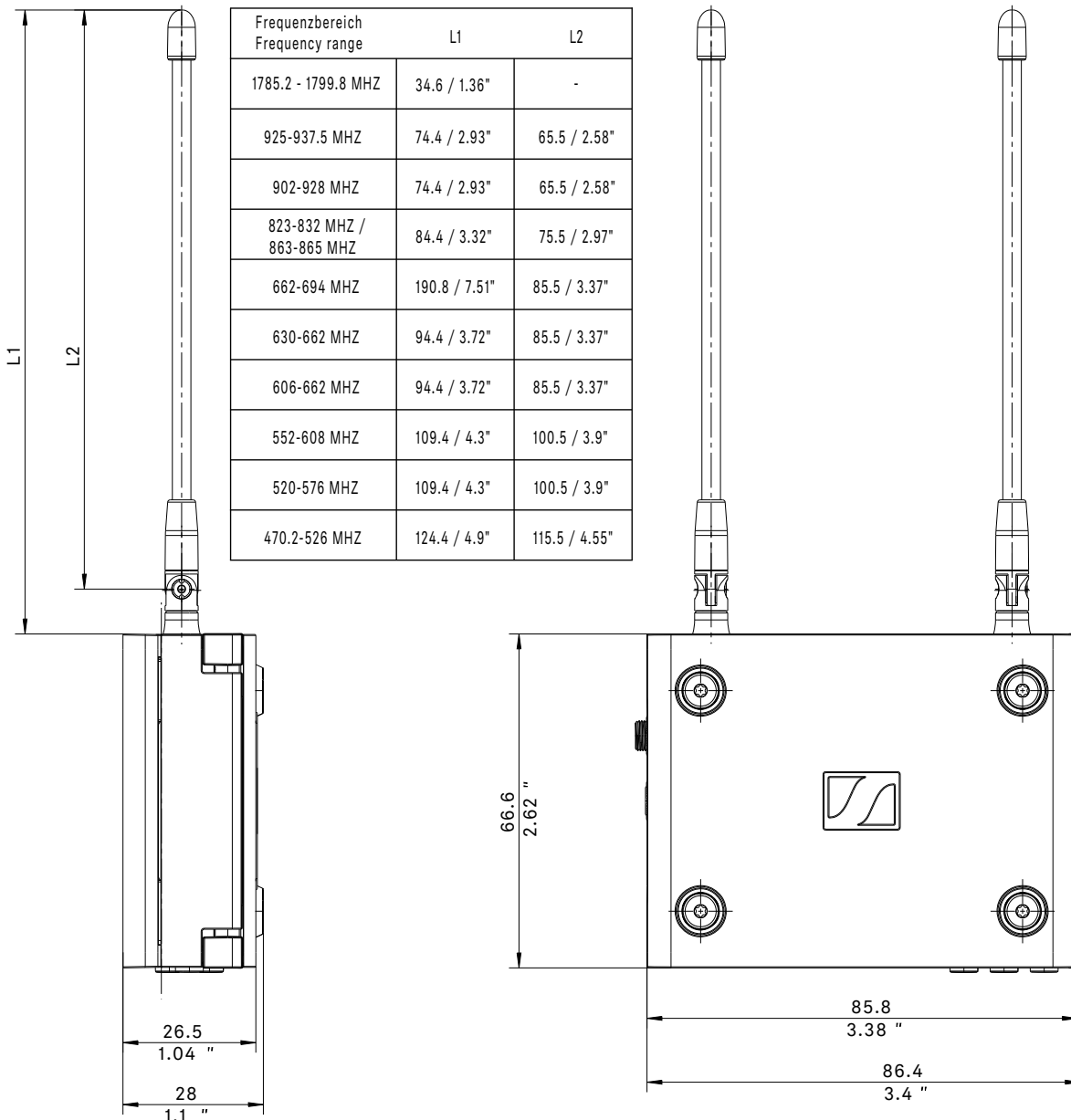
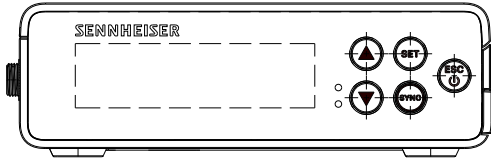



Evolution Wireless Digital EW-DP 835 SET | Handheld Set

DIMENSIONS

EW-D SKM-S

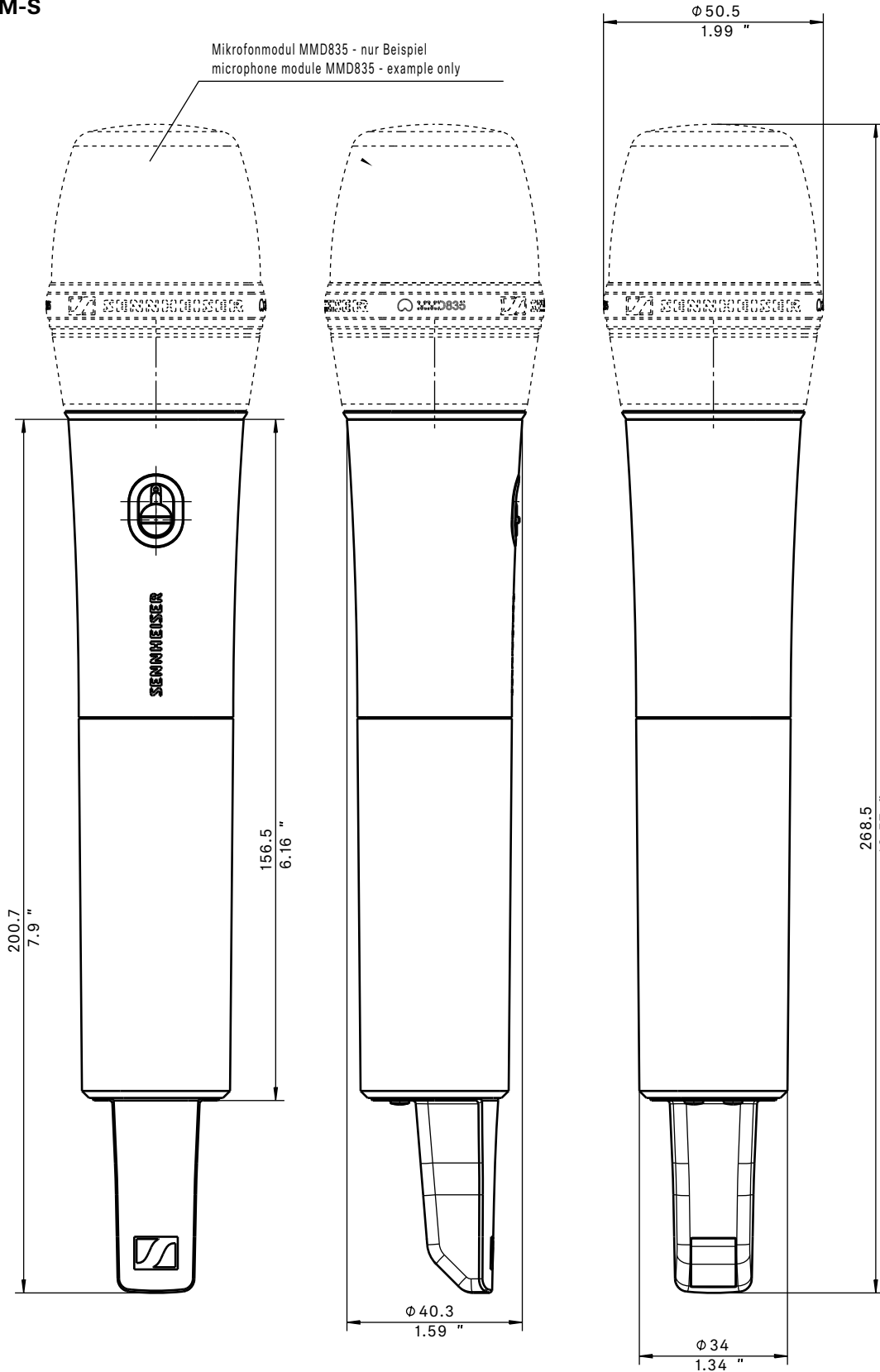



Evolution Wireless Digital EW-DP 835 SET | Handheld Set

DIMENSIONS

Mounting Accessories

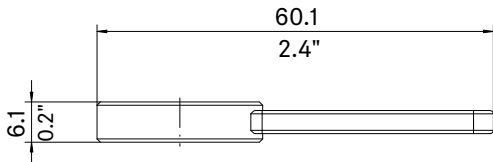
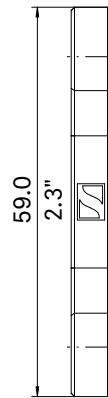
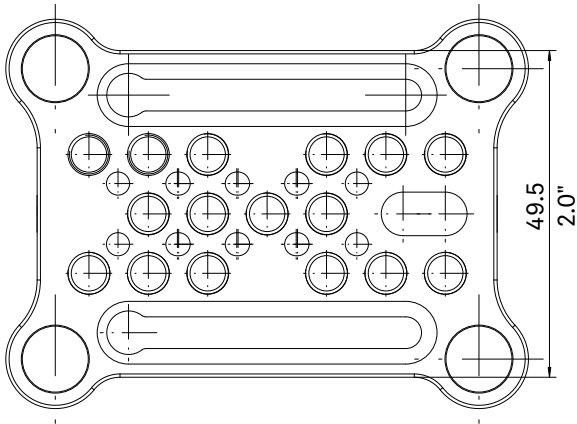
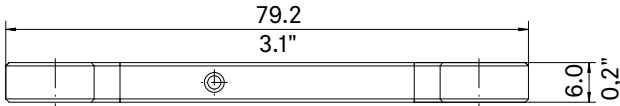

Montagemaße in Anlehnung an ISO 518
Mounting dimensions according to ISO 518

